

RE4R01A, RE5R01A

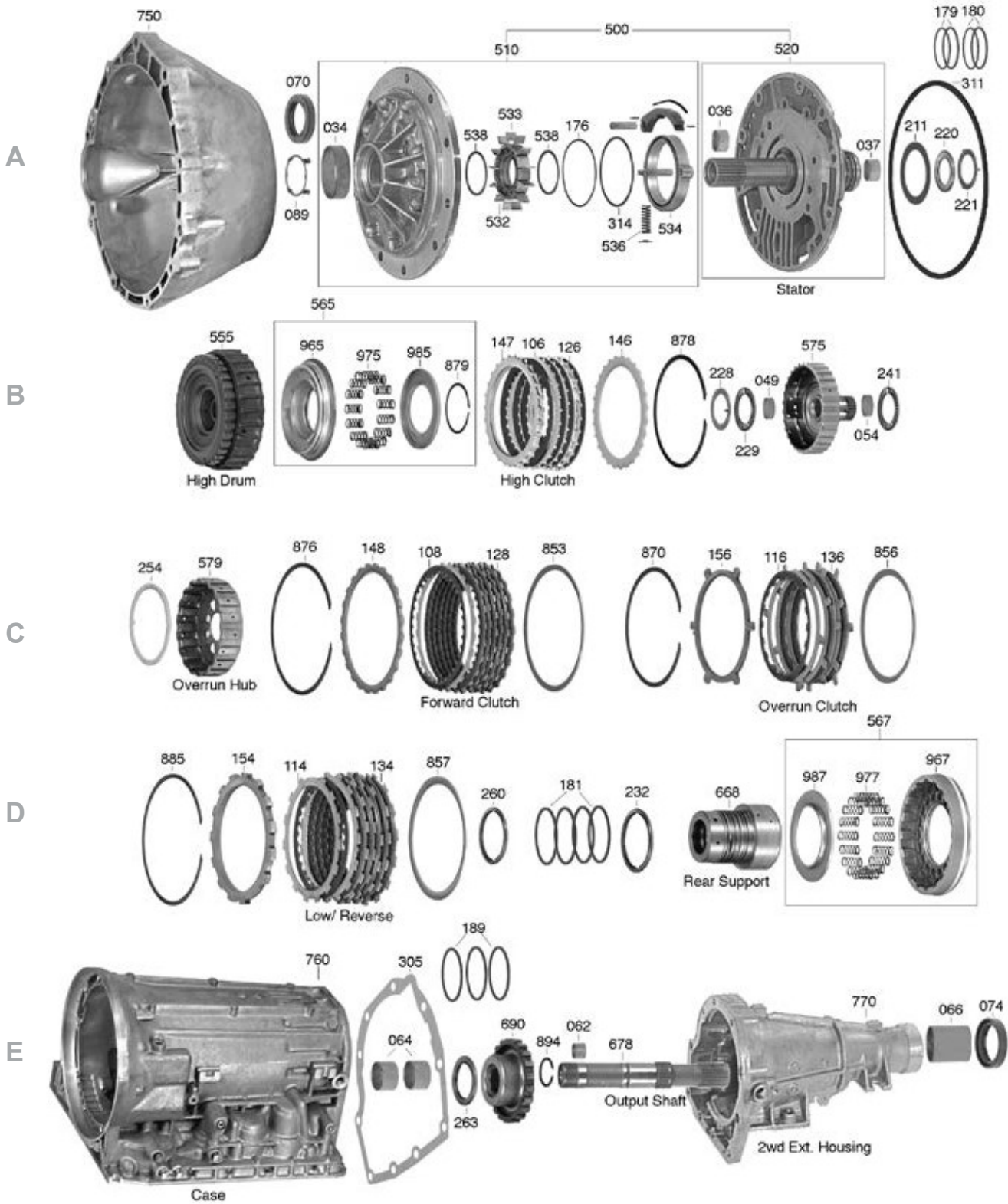

NISSAN

RE4R01A, RE5R01A

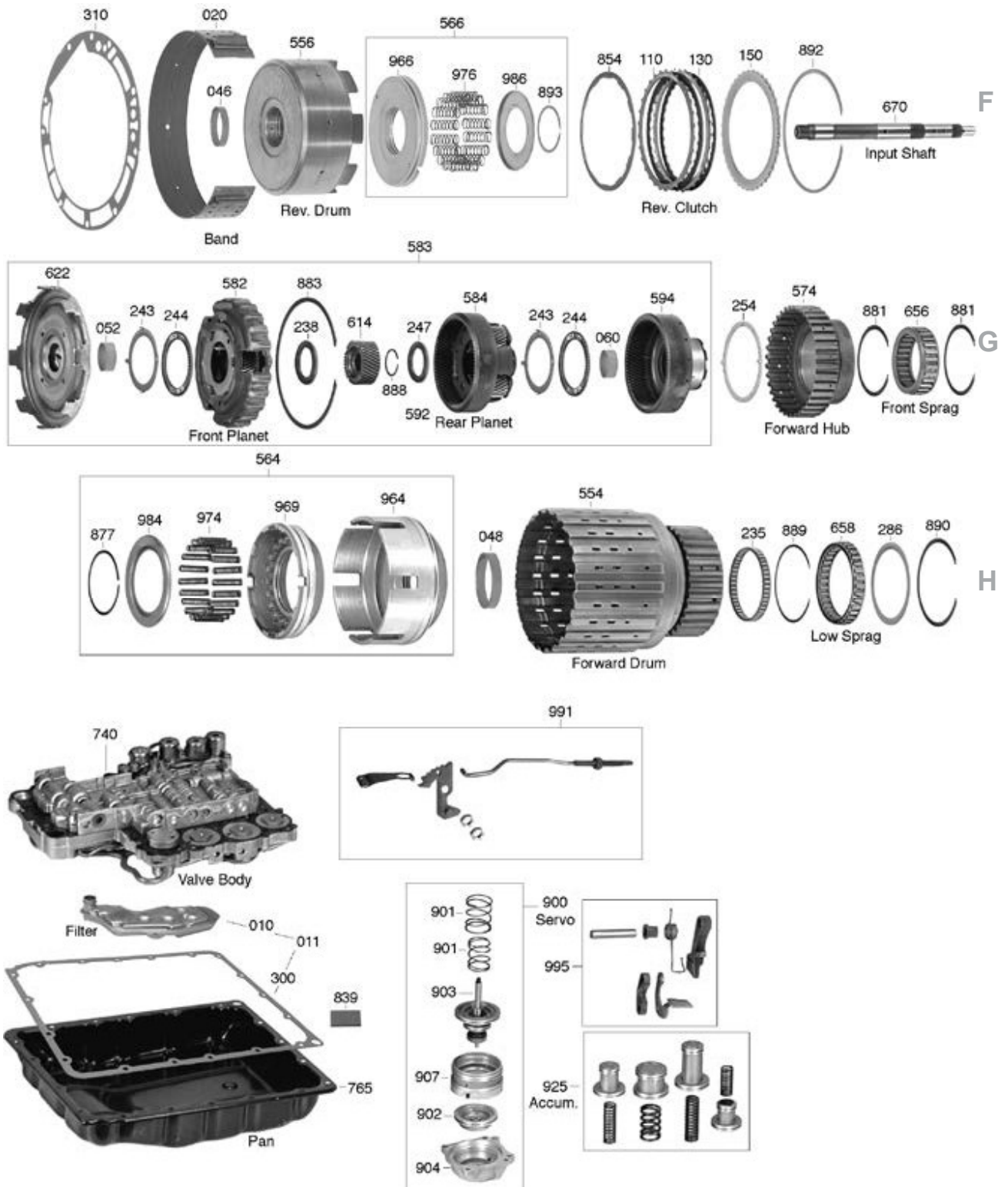

RE4R01A, RE5R01A

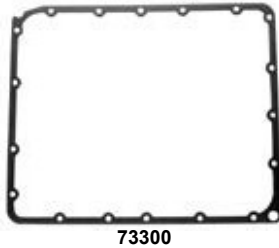

ILL.		QTY.	YEAR	PART No.	REF. No.
MASTER OVERHAUL KITS (WITH STEELS)					
006	Nissan (2wd Exc 300ZX Non Turbo, Infiniti J30) (All Mazda)	1	89-92	73006AF	N.L.
006	Nissan (2wd Exc 300ZX Non Turbo, Infiniti J30) (All Mazda 93-1/95)	1	93-E96	73006ABF	N.L.
006	Nissan (4wd, Also 300ZX Non Turbo, Infiniti J30)	1	87-92	73006BF	N.L.
006	Nissan (4wd, Also 300ZX Non Turbo, Infiniti J30) (All Mazda 1/95-98)	1	93-E96	73006BBF	N.L.
006	Nissan (Exc 1/00-04 Pathfinder & QX4, 01-04 Supercharged Frontier, Xterra)	1	L96-Up	73006DF	N.L.
006	Nissan (1/00-04 Pathfinder & QX4, 01-04 Supercharged Frontier & Xterra)	1	E00-04	73006HF	N.L.
006	Nissan (RE5R01A) (5 Speed) (Non USA)	1	91-Up	73006RF	N.L.
LESS STEEL KITS					
004	Nissan (2wd Exc 300ZX Non Turbo, Infiniti J30) (All Mazda)	1	89-92	73004AF	N.L.
004	Nissan (2wd Exc 300ZX Non Turbo, Infiniti J30) (All Mazda 93-1/95)	1	93-E96	73004ABF	N.L.
004	Nissan (4wd, Also 300ZX Non Turbo, Infiniti J30)	1	87-92	73004BF	N.L.
004	Nissan (4wd, Also 300ZX Non Turbo, Infiniti J30) (All Mazda 1/95-98)	1	93-E96	73004BBF	N.L.
004	Nissan (Exc 1/00-04 Pathfinder & QX4, 01-04 Supercharged Frontier, Xterra)	1	L96-Up	73004DF	N.L.
004	Nissan (1/00-04 Pathfinder & QX4, 01-04 Supercharged Frontier & Xterra)	1	E00-04	73004HF	N.L.
004	Nissan (RE5R01A) (5 Speed) (Non USA)	1	91-Up	73004RF	N.L.
OVERHAUL KITS (W/ RINGS & SEALS)					
002	RL4R01A, RE4R01A, R4A-EL (4 Speed)	1	87-Up	73002AF	N.L.
002	RE5R01A (5 Speed) (Non USA)	1	91-Up	73002RF	N.L.
FILTER KITS					
011	Nissan (4 Cyl 2wd) (.125" Pick-Up Tube)	1	90-Up	A73011AA	N.L.
011	Nissan (6 Cyl 2wd) (.300" Pick-Up Tube) (All Metal) (1)	1	89-Up	A73011A	N.L.
011	Nissan (6 Cyl 2wd) (.900" Pick-Up Tube) (All Metal) (2) (12/98-Up)	1	L98-Up	A73011BA	N.L.
011	Nissan (4wd) (.900" Pick-Up Tube) (All Metal)	1	87-Up	A73011BA	N.L.
011	Mazda (Exc. RX7 (.900" Pick-Up Tube)	1	89-Up	A73011BA	N.L.
011	Mazda (RX7) (1.875" Pick-Up Tube)	1	93-96	A73011C	N.L.
	(1) does not fit 2wd Supercharged Frontier/Xterra, 12/98-Up 2wd Pathfinder) ..				
	(2) Fits 2wd Supercharged Frontier/Xterra, 12/98-Up 2wd Pathfinder)				
FILTERS					
010H	Nissan 4 Cyl 2wd (.125" Pick-Up Tube)	1	90-Up	A73010AA	31728-48X00
010H	Nissan 6 Cyl 2wd (.160" Pick-Up Tube) (Filtran Metal & Plastic) (1)	1	89-Up	73010A	31728-41X00
010H	Nissan (6 Cyl 2wd) (.300" Pick-Up Tube) (All Metal) (1)	1	89-Up	A73010A	31728-41X00
010H	Nissan 6 Cyl 2wd (.750" Pick-Up Tube) (Filtran Metal & Plastic) (2)	1	99-Up	73010B	31728-41X03
010H	Nissan 4wd (.750" Pick-Up Tube) (Filtran Metal & Plastic)	1	87-Up	73010B	31728-41X03
010H	Nissan 4wd (.900" Pick-Up Tube) (All Metal)	1	87-Up	A73010D	31728-41X01
010H	Mazda (Exc. RX7) (.900" Pick-Up Tube)	1	89-Up	A73010D	BV92-19-815
010H	Mazda RX7 (1.875" Pick-Up Tube)	1	93-96	A73010C	BV65-19-815
	(1) does not fit 2wd Supercharged Frontier/Xterra, 12/98-Up 2wd Pathfinder) ..				
	(2) Fits 2wd Supercharged Frontier/Xterra, 12/98-Up 2wd Pathfinder)				
BANDS					
020F	Overdrive (1.500" Wide) (Only One End Has Tab)	1	87-Up	73020	31630-AA010
020F	Overdrive (1.500" Wide) (Both Ends Same)	1	99-Up	93020	31630-21X00
020F	Overdrive (2.362" Wide) (Both Ends Same) (1/00-04)	1	L00-04	73020A	31630-4AX00
BUSHINGS					
030	Bushing Kit	1	87-Up	73030	N.L.
034A	Pump Body	1	87-Up	93034	31343-21X01
036A	Stator (Front) (.845" ID)	1	87-Up	73036	N.L.
036A	Stator (Front) (.945" ID)	1	87-Up	73036A	31405-41X02
037A	Stator (Rear)	1	87-Up	93037	31363-21X01

NISSAN

RE4R01A, RE5R01A

ILL.		QTY.	YEAR	PART No.	REF. No.
BUSHINGS (Cont.)					
046F	Reverse Drum.....	1	87-Up	93046	31513-21X00
048F	Forward Drum.....	1	87-Up	73048	N.L.
052F	Front Sun Gear (Shell).....	1	87-Up	93052	31462-21X04
054B	High Clutch Hub.....	2	87-Up	73054	31548-21X01
060G	Rear Ring Gear.....	1	87-Up	73060	N.L.
062E	Output Shaft (Front).....	1	87-Up	73062	N.L.
064E	Case (1.266" ID).....	2	87-Up	73064	31405-41X00
064E	Case (Bronze 1 Piece, Replaces the 2 Case Bushings).....	1	87-Up	73064B	N.L.
066E	Extension Housing.....	1	87-Up	73066	31332-X8000R
METAL CLAD SEALS					
070A	Front.....	1	87-Up	93070	31344-21X00
072	Manual Lever.....	1	87-Up	73072	BV11-19-437
074E	Extension Housing (Nissan, Infiniti).....	1	87-Up	53074B	31336-X8000
074E	Extension Housing (Mazda Exc. 93-Up RX7).....	1	87-Up	53074D	M502-17-335A
074E	Extension Housing (Mazda 93-Up RX7).....	1	93-Up	73074B	BV65-19-437
074E	Adapter Housing (Mazda 4wd).....	1	87-Up	73074C	M504-17-335
074E	Adapter Housing (Nissan 4wd).....	1	87-Up	73074D	31366-X6901
089A	Seal Retainer, Front Seal Lock.....	1	87-Up	73089	N.L.
FRICTION PLATES					
106B	High (.063") (30T).....	4-5	87-Up	93106B	31532-AA050
108C	Forward (.063") (36T).....	5-8	87-Up	73108A	31532-AA110
108C	Forward (.079") (36T).....	5-6	89-Up	73108	31532-AA060
110F	Reverse (.079") (30T).....	2	93-Up	73110AA	31532-41X19
110F	Reverse (.079") (34T).....	2	87-92	93110A	31532-AA030
114D	Low/ Reverse (.079") (30T).....	6-8	87-Up	73114	31662-AA050
114D	Low/ Reverse (.063").....	5-7	L96-Up	23114A	31532-41X69
116C	Overrun (.079") (18T).....	3	87-Up	73116	31532-AA070
N.I.	Reduction Brake (RE5R01A Only).....	3	91-Up	73102M	31532-60X02
N.I.	Reduction Direct (RE5R01A Only).....	3	91-Up	73106M	31532-60X03
STEEL PLATES					
126B	High (.067").....	4-7	87-Up	73126	31536-41X04
126B	High (.079").....	3-5	87-Up	93126BA	31536-41X03
126B	High (.118").....	AR	87-Up	93126B	31536-AA030
128C	Forward (.071") (24T).....	6-8	87-Up	73128	31536-41X13
128C	Forward (.079") (24T).....	6	89-Up	73128A	31536-AA080
130F	Reverse (.079") (5.080" ID).....	2	93-Up	73130B	31536-AA100
130F	Reverse (.079") (5.350" ID).....	2	87-92	93130A	31536-AA000
130F	Reverse (.110") (5.080" ID) (V-Tooth).....	2	00-Up	73130C	31536-41X20
134D	Low/ Reverse (.079") (14T).....	6-8	87-Up	73134	31666-AA020
136C	Overrun (.079") (4.700" ID) (6T).....	3-5	87-Up	73136	31536-AA090
N.I.	Reduction Brake (.079") (RE5R01A Only).....	1	91-Up	73120	31536-60X03
N.I.	Reduction Brake (.102") (RE5R01A Only).....	2	91-Up	73120A	31536-60X02
N.I.	Reduction Direct (RE5R01A Only).....	5	91-Up	73122	31536-60X00
PRESSURE PLATES					
146B	High Clutch (3.6mm) (27T).....	1	87-Up	73146A	31537-41X61
146B	High Clutch (4.0mm) (27T).....	1	87-Up	73146AB	31567-41X63
146B	High Clutch (4.2mm) (27T).....	1	87-Up	73146AC	N.L.
146B	High Clutch (4.4mm) (27T).....	1	87-Up	73146AD	31537-41X65
150F	Reverse Clutch (5.0mm) (30T).....	1	87-Up	73150AB	N.L.
VALVE BODY RECALIBRATION KITS					
165	Shift Kit® (Transgo®).....	1	88-Up	T73165A	SK® RE4R01A
165	Shift Correction Package (RE4R01A) (Superior).....	1	88-Up	S73165A	KRE4R01A
SEALING RINGS					
175H	Ring Kit.....	1	87-Up	73175	N.L.
THRUST WASHERS					
211A	Stator to Reverse Drum .028" (Plastic).....	1	87-Up	93211	31528-21X00
211A	Stator to Reverse Drum .035" (Plastic).....	1	87-Up	93211A	31528-21X01
211A	Stator to Reverse Drum .043" (Plastic).....	1	87-Up	93211B	31528-21X02
211A	Stator to Reverse Drum .051" (Plastic).....	1	87-Up	93211C	31528-21X03
211A	Stator to Reverse Drum .067" (Plastic).....	1	87-Up	93211E	31528-21X05

RE4R01A, RE5R01A

ILL.		QTY.	YEAR	PART No.	REF. No.
THRUST WASHERS (Cont.)					
211A	Stator to Reverse Drum .075" (Plastic).....	1	87-Up	93211F	31528-21X06
254C	Rear Planet Ring Gear to Clutch Hub 3 13/16" OD (Plastic).....	2	87-Up	73254	31508-41X01
BEARINGS & RACES					
201	Bearing Kit, w/ Washers.....	1	87-Up	73201A	N.L.
201	Bearing Kit, Planet Assembly.....	1	87-Up	73201	N.L.
220A	Bearing w/ Race, Stator to High Drum.....	1	87-Up	73220	31407-41X07
221A	Race, Stator to High Drum .055" (Metal w/ 3 Outer Tabs).....	1	87-Up	93221AB	31429-21X03
221A	Race, Stator to High Drum .063" (Metal w/ 3 Outer Tabs).....	1	87-Up	93221AC	31429-21X04
221A	Race, Stator to High Drum .079" (Metal w/ 3 Outer Tabs).....	1	87-Up	93221AE	31429-21X06
228B	Race, High Drum to Hub (Metal w/ 3 Inner Tabs).....	1	87-Up	73228	31439-21X00
232D	Bearing w/ Race, High Drum to Hub (Also High Hub to Sun Shell).....	1	87-Up	53232	31436-X0100
232D	Bearing, Forward Drum to Hub (Update Replaces Bearing w/ Race).....	2	87-Up	73232B	31407-41X05
238G	Bearing w/ Race, Front Planet to Rear Sun Gear.....	1	87-Up	73238	31407-41X08
243G	Race, Shell to Front Planet & Rear Planet to Ring Gear.....	2	87-Up	73243	31464-21X00
244G	Bearing w/ Race, Shell to Front Planet & Rear Planet to Rear Ring Gear.....	2	87-Up	73244	31435-21X00
244G	Bearing w/ Race Kit, Includes (1) 73243 & (1) 73244.....	1	87-Up	73244K	31435-41X00
247G	Bearing w/ Race, Rear Sun Gear to Rear Planet.....	1	87-Up	73247	31455-21X00
260D	Bearing w/ Race, Overrun Hub to Rear Support.....	1	87-Up	73260	31407-41X04
260D	Bearing w/ 2 Races, Overrun Hub to Rear Support.....	1	87-Up	73260A	31407-41X11
263H	Bearing w/ Race, Case to Park Gear.....	1	87-Up	73263	31407-41X06
GASKETS & O-RINGS					
300H	Gasket, Bottom Pan (Cork).....	1	87-Up	73300	31397-41X01
300H	Gasket, Bottom Pan (Fiber).....	1	87-Up	73300F	31397-41X01
305E	Gasket, Extension Housing.....	1	87-Up	73305A	31338-41X01
310F	Gasket, Pump.....	1	87-Up	73310A	31366-41X03
311A	O-Ring, Pump.....	1	87-Up	73311	31526-41X01
320	Gasket Kit, Valve Body (RE4R01A, R4A-EL).....	1	87-Up	73320K	N.L.
379	O-Ring, Filter.....	1	87-Up	73379	N.L.
TECHNICAL MANUALS					
400H	Tech Manual, RE4R01A.....	1	87-Up	73400	RE4R01
400H	Tech Manual, RL4R01A.....	1	87-Up	73400A	RL4R01A
ELECTRICAL COMPONENTS					
420	Solenoid Assembly (4 Solenoids, 2 Insulated Connectors, 1 Ground Wire).....	1	L88-Up	73420A	31940-41X09
425	Solenoid, Lock-Up (RE4, JR403A) (Non PWM).....	1	87-Up	73425	31940-41X10
425	Solenoid, Lock-Up (R4A-EL) (PWM) (Some Mazda) (2 Piece).....	1	92-Up	73425B	BV65-21-1D1
425	Solenoid, Lock-Up (RL4).....	1	90-Up	73425A	31940-48X02
425	Solenoid, Overdrive Cancel (RL).....	1	90-Up	73425A	31940-48X02
PUMPS					
500A	Pump Complete (Front Stator Bushing .845" ID) (RL4R01A w/ Lugs).....	1	87-Up	73500A	N.L.
500A	Pump Complete (Front Stator Bushing .845" ID) (RL4R01A w/ Flats).....	1	87-Up	73500AE	N.L.
500A	Pump Complete (Front Stator Bushing .945" ID, Switch on Back) (w/ Sensor).....	1	87-Up	73500AB	N.L.
500A	Pump Complete (Front Stator Bushing .945" ID, No Switch) (w/o Sensor).....	1	87-Up	73500AA	N.L.
500A	Pump Complete (Milled Flats on Rotor) (w/ Sensor).....	1	87-Up	73500AC	N.L.
500A	Pump Complete (Milled Flats on Rotor) (w/o Sensor).....	1	93-Up	73500AD	N.L.
DRUMS & CLUTCH HUBS					
554H	Forward (Low/ Reverse Clutch Hub Spline Length is 1.645" Tall).....	1	87-Up	73554A	31571-41X26
554H	Forward (Low/ Reverse Clutch Hub Spline Length is 1.765" Tall).....	1	87-Up	73554	N.L.
555B	High (w/ 34T Reverse Hub).....	1	87-92	73555	N.L.
555B	High (w/ 30T Reverse Hub).....	1	93-Up	73555A	N.L.
556E	Reverse (1.575" Band).....	1	87-Up	73556	31511-41X04
556E	Reverse (2.360" Band) (3.5L).....	1	02-Up	73556B	31511-41X06
854F	Reverse Drum Saver Kit (Waved Cushion Plate Fix by Alto).....	1	87-92	73854K	N.L.
854F	Reverse Drum Saver Kit (Waved Cushion Plate Fix by Alto).....	1	93-Up	73854AK	N.L.
574G	Clutch Hub, Forward (1.330" Tall At Clutch Splines).....	1	87-Up	73574	N.L.
575B	Clutch Hub, High (All 87-89).....	1	87-89	73575	269165E
575B	Clutch Hub, High (90-Up 2wd).....	1	90-Up	73575A	N.L.
575B	Clutch Hub, High (90-Up 4wd).....	1	90-Up	73575	269165E
579C	Clutch Hub, Overrun.....	1	87-Up	73579	31591-41X01

NISSAN

RE4R01A, RE5R01A

ILL.		QTY.	YEAR	PART No.	REF. No.
PLANETS					
582G	Front (No Groove).....	1	87-Up	73582A	31420-41X08
583G	Planet Kit (Includes # 622 to # 594) (37T Rear Sun Gear).....	1	87-Up	73583	N.L.
583G	Planet Kit (Includes # 622 to # 594) (42T Rear Sun Gear).....	1	87-Up	73583B	N.L.
583G	Planet Kit (Includes # 622 to # 579) (42T Rear Sun Gear).....	1	87-Up	73583BA	N.L.
ONE WAY CLUTCHES					
656G	Sprag, Forward.....	1	87-Up	73656	31484-41X00
658H	Sprag, Low Sprag (30 Elements) (Replaced by D73554A Drum).....	1	87-92	D73554A	31571-41X26
658H	Sprag, Low Sprag (30 Elements).....	1	87-Up	73658A	31473-41X02
REAR SUPPORTS					
668D	Rear Support (w/ 4 Lube Holes on Sprag Area) (2nd Design).....	1	87-Up	73668A	N.L.
SHAFTS					
670F	Input Shaft (12.375" Long, w/ 18 Spline on Converter End).....	1	87-Up	73670AE	N.L.
670F	Input Shaft (12.375" Long, w/ 20 Spline on Converter End).....	1	87-Up	73670	N.L.
678E	Output Shaft, 4wd (13" Long, w/ 30 Splines).....	1	87-Up	73678AA	N.L.
678E	Output Shaft, 4wd (13.625" Long, w/ 30 Splines).....	1	87-Up	73678	N.L.
GOVERNORS					
680	Governor, RL4R01A.....	1	87-Up	73680A	N.L.
VALVE BODIES					
740H	Valve Body (Premium) RL4R01A (2 Solenoids).....	1	87-Up	P73740-3	N.L.
740H	Valve Body (Premium) RE4R01A (5 Solenoids).....	1	87-Up	P73740-2	N.L.
740H	Valve Body (Premium) R4A-EL (Mazda) (5 Solenoid).....	1	89-98	P73740-1	N.L.
740H	Valve Body (Premium) R4A-EL (Mazda) (6 Solenoid).....	1	92-Up	P73740-4	N.L.
MISCELLANEOUS COMPONENTS					
761H	Sleeve, Governor Bore (Non Electronic Units Only).....	1	87-89	73761A-2	69835
854F	Reverse Drum Saver Kit (Waved Cushion Plate Fix).....	1	87-92	73854K	N.L.
854F	Reverse Drum Saver Kit (Waved Cushion Plate Fix).....	1	93-Up	73854AK	N.L.
915	Strut, Servo Band.....	1	87-Up	73915-2	69700-01
VOL. SONNAX PRODUCTS					
Vol 9	Elevated Pressure Main Press Reg Spring (88-94) (20 per bag) (RE4R01A).....	N.I.	N.I.	S73741PA-3	69880-01
Vol 9	Elevated Pressure Main Press Reg Spring (95-Up) (20 per bag) (RE4R01A).....	N.I.	N.I.	S73741PB-3	69880-02
Vol 9	Servo Pin Kit w/ O-Ring (RE4R01A, RL4R01A).....	N.I.	N.I.	S73903	69903-01K
Vol 9	Governor Bore Sleeve (RL4R01A).....	N.I.	N.I.	A73761A-2	69835

Notes

RE4R01A, RE5R01A - FILTERS

73010A



73010B
Replaced by
A73010D



A73010A



A73010AA



A73010B
Replaced by
A73010D



A73010C



A73010D



Notes

