

NISSAN

RE5R05A

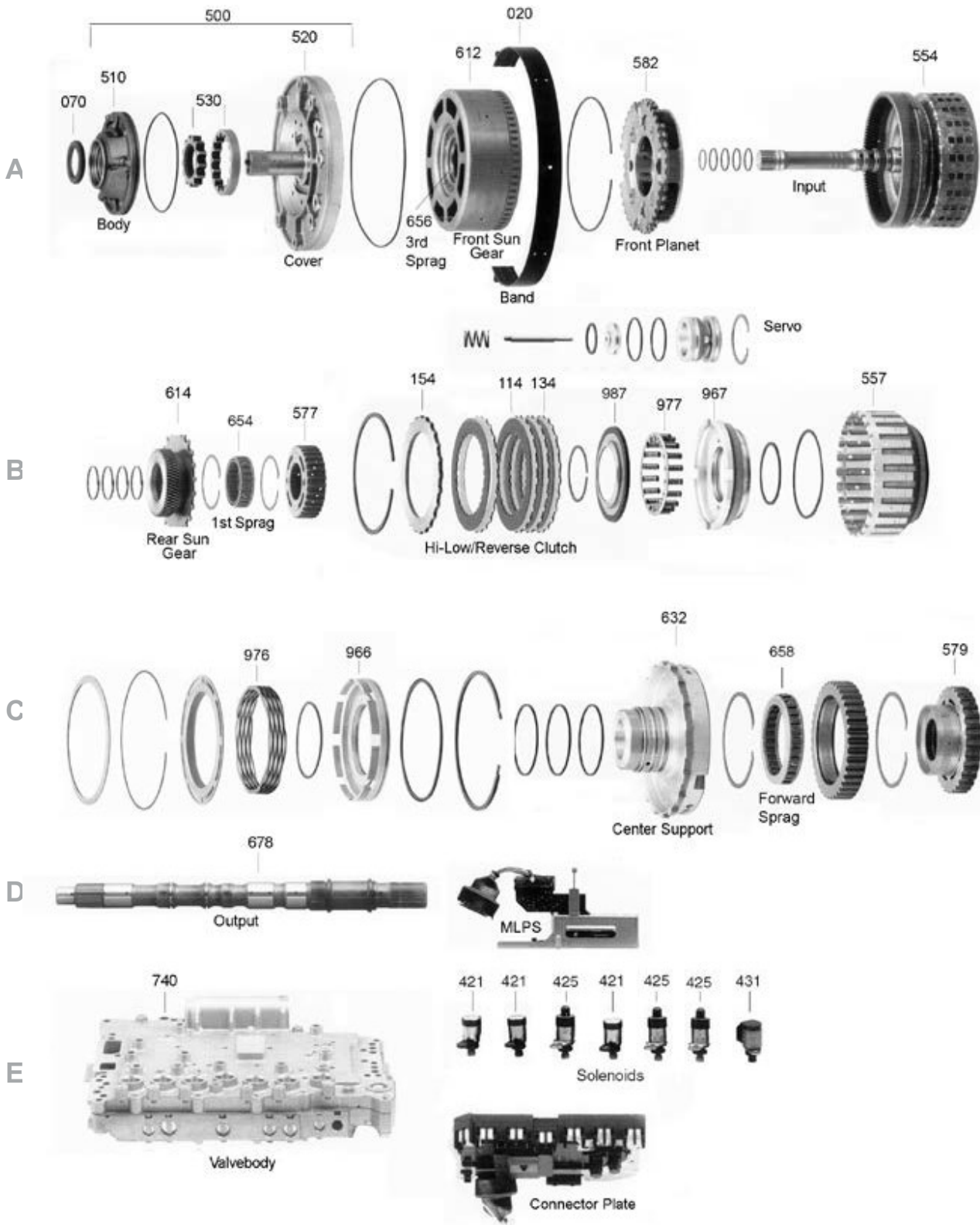

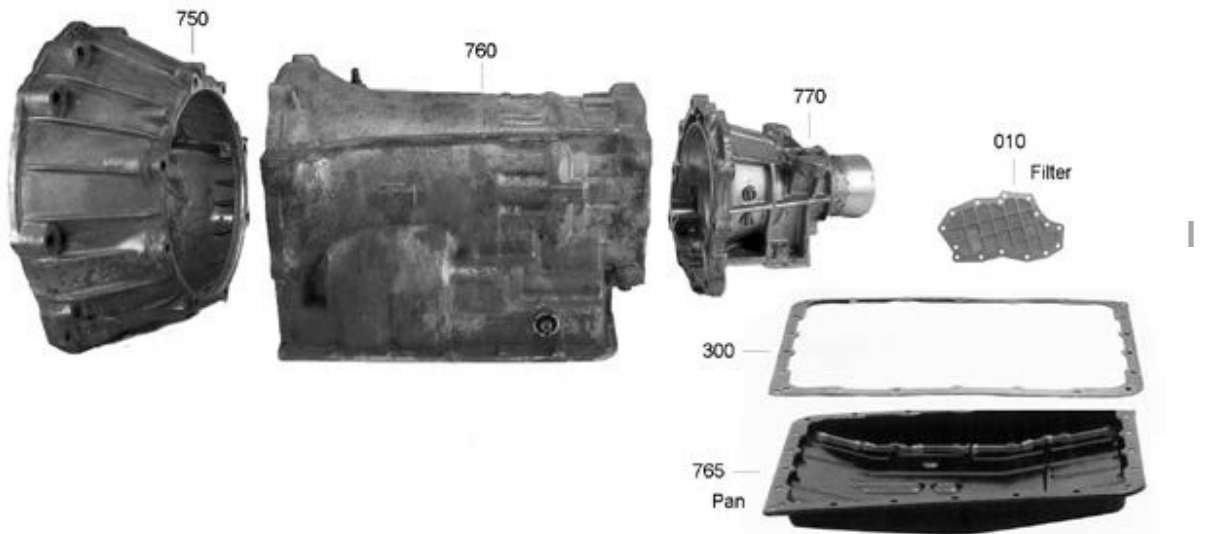
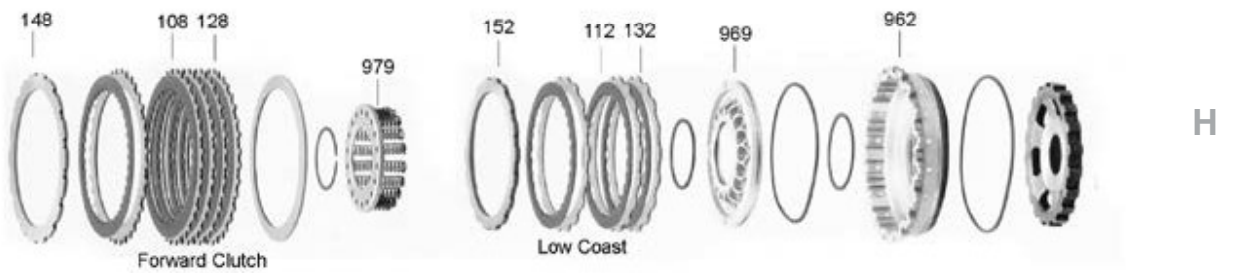
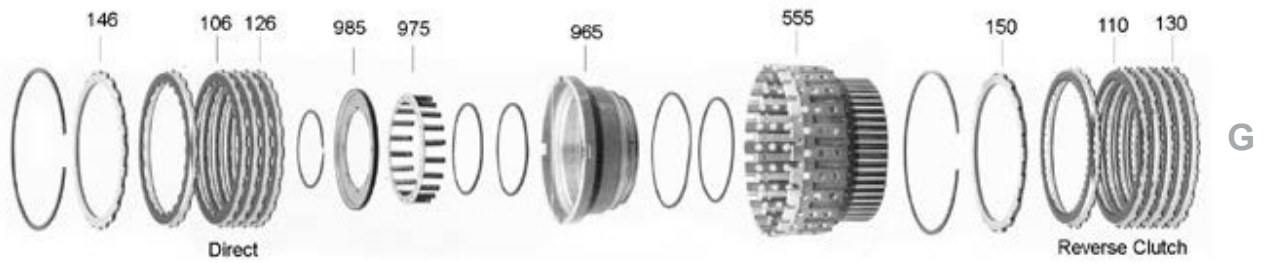
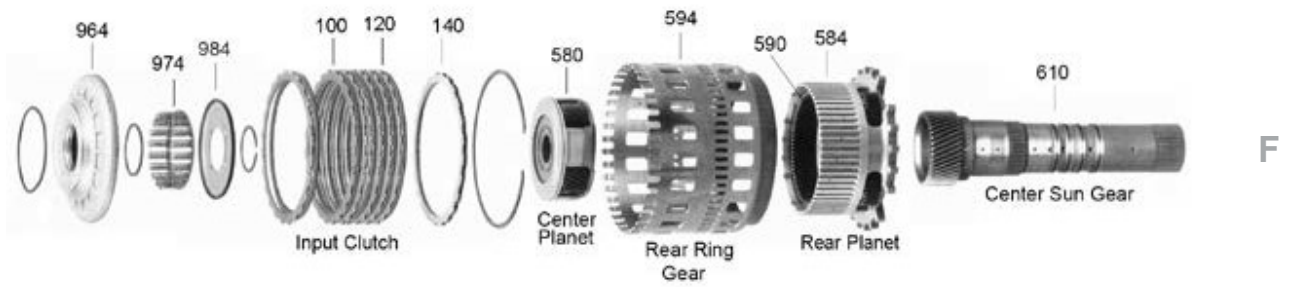

NISSAN

RE5R05A

VALVE BODY GUIDE

| | Part | Year | Trans. | |
|----------|----------|-------|---------|---------------------------------------|
| A | P63740-3 | 41703 | RE5R05A | w/1st design TCM low OHM coast (2,3) |
| | P63740-4 | 41675 | RE5R05A | w/1st design TCM high OHM coast (2,3) |
| | P63740-1 | 41703 | RE5R05A | w/o TCM low OHM coast (2,3) |
| | P63740-2 | 41675 | RE5R05A | w/o TCM high OHM coast (2,3) |
| B | P63740-5 | 06-Up | RE5R05A | w/2nd design TCM/1 Accumulator Bore |

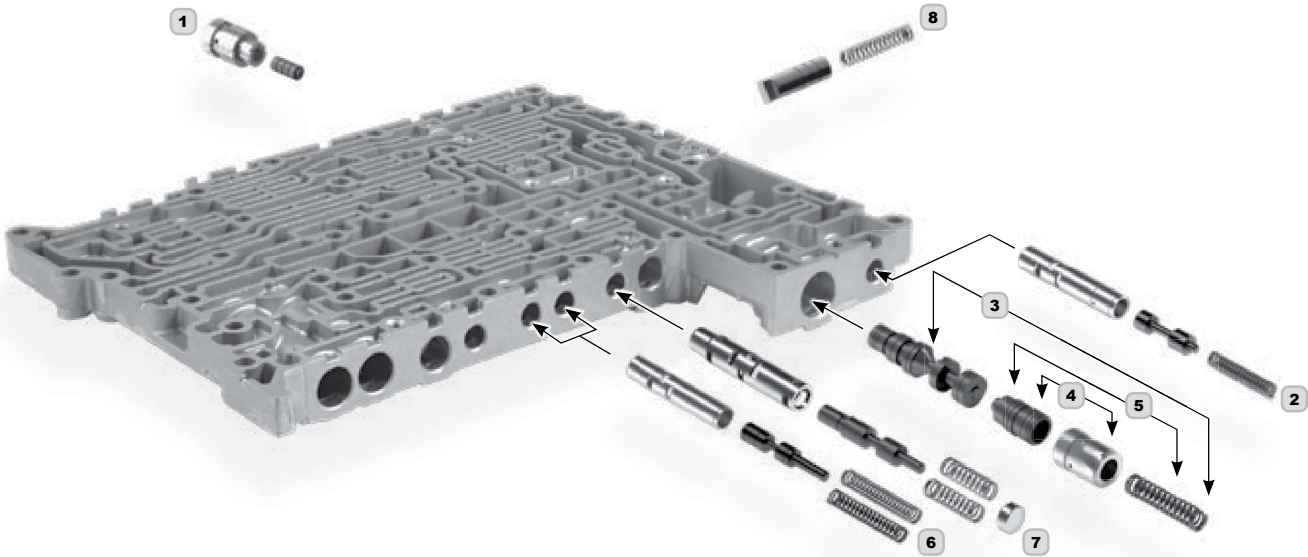
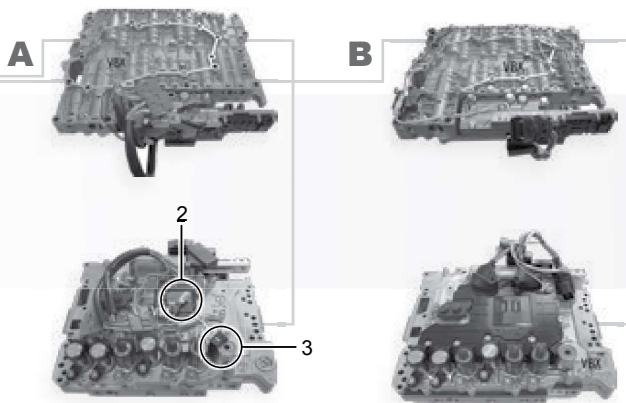

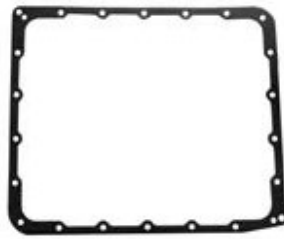

63300



63010

| ILL. | | QTY. | YEAR | PART No. | REF. No. |
|---|---|------|-------|----------|-------------|
| MASTER OVERHAUL KITS (WITH STEELS) | | | | | |
| 006 | RE5R05A (w/ Pistons*) (Exc. Pathfinder, Titan, Armada, QX56)..... | 1 | 02-Up | 63006P | N.L. |
| 006 | RE5R05A (w/ Pistons*) (Titan, Armada, QX56)..... | 1 | 04-Up | 63006AP | N.L. |
| 006 | RE5R05A (w/ Pistons*) (Pathfinder)..... | 1 | 05-Up | 63006CP | N.L. |
| | (*) For Kits w/out Pistons, replace the P with an N - for example 63004N..... | | | | |
| LESS STEEL KITS | | | | | |
| 004 | RE5R05A (w/ Pistons*) (Exc. Pathfinder, Titan, Armada, QX56)..... | 1 | 02-Up | 63004P | N.L. |
| 004 | RE5R05A (w/ Pistons*) (Titan, Armada, QX56)..... | 1 | 04-Up | 63004AP | N.L. |
| 004 | RE5R05A (w/ Pistons*) (Pathfinder)..... | 1 | 05-Up | 63004P | N.L. |
| | (*) For Kits w/out Pistons, replace the P with an N - for example 63004N..... | | | | |
| OVERHAUL KITS (W/ RINGS & SEALS) | | | | | |
| 002 | RE5R05A (w/out Pistons**)..... | 1 | 02-Up | 63002N | N.L. |
| | (**) For Kits w/ Pistons, replace the N with a P - for example 63002P..... | | | | |
| FILTER KITS | | | | | |
| 011 | Filter Kit, RE5R05A..... | 1 | 02-Up | 63011 | N.L. |
| FILTERS | | | | | |
| 010I | Filter, RE5R05A..... | 1 | 02-Up | 63010 | N.L. |
| BANDS | | | | | |
| 020A | Band, 3-5..... | 1 | 02-Up | 63020 | 31630-90X00 |
| BUSHINGS | | | | | |
| N.I. | Bushing Kit..... | 1 | 02-Up | 63030 | N.L. |
| N.I. | Pump..... | 1 | 02-Up | 63034 | N.L. |
| METAL CLAD SEALS | | | | | |
| 070A | Converter (Front)..... | 1 | 02-Up | 93070 | 31344-21X00 |
| N.I. | Rear (2wd)..... | 1 | 02-Up | 73074D | 31366-X6901 |
| N.I. | Rear (4wd)..... | 1 | 02-Up | 63074 | N.L. |
| N.I. | Shift Lever..... | 2 | 02-Up | 60072 | 91209612003 |
| FRICITION PLATES | | | | | |
| 100F | Input..... | 7 | 02-Up | 63100 | N.L. |
| 106G | Direct..... | 5-6 | 02-Up | 63106 | N.L. |
| 108H | Forward..... | 5 | 02-Up | 63108 | N.L. |
| 110G | Reverse (40T) (Titan, Armada, QX56)..... | 7 | 04-Up | 63110A | N.L. |
| 110G | Reverse (50T) (Exc Titan, Armada, QX56)..... | 6 | 02-Up | 63110 | N.L. |
| 112H | Low Coast..... | 3 | 02-Up | 63112 | N.L. |
| 114B | High & Low/ Reverse..... | 5 | 02-Up | 63114 | N.L. |
| STEEL PLATES | | | | | |
| 120F | Input..... | 7 | 02-Up | 63120 | N.L. |
| 126G | Direct..... | 5-6 | 02-Up | 63126 | N.L. |
| 128H | Forward (18 Wide Teeth) (Exc Titan, Armada, QX56, Pathfinder)..... | 5 | 02-Up | 63128 | N.L. |
| 128H | Forward (16 Narrow Teeth) (Titan, Armada, QX56, Pathfinder)..... | 5 | 04-Up | 63128A | N.L. |
| 130G | Reverse (.063") (Titan, Armada, QX56)..... | 7 | 02-Up | 63130A | N.L. |
| 130G | Reverse (.079") (Exc Titan, Armada, QX56)..... | 6 | 02-Up | 63130 | N.L. |
| 132H | Low Coast (18 Wide Teeth) (Exc Titan, Armada, QX56, Pathfinder)..... | 3 | 02-Up | 63132 | N.L. |
| 132H | Low Coast (15 Narrow Teeth) (Titan, Armada, QX56, Pathfinder)..... | 3 | 04-Up | 63132A | N.L. |
| 134B | High & Low/ Reverse (.266" Wide Teeth) (Exc Titan, Armada, Q56)..... | 5 | 02-Up | 63134 | N.L. |
| 134B | High & Low/ Reverse (.425" Wide Teeth) (Titan, Armada, Q56)..... | 5 | 04-Up | 63134A | N.L. |

NISSAN

RE5R05A

| ILL. | | QTY. | YEAR | PART No. | REF. No. |
|--------------------------------------|--|------|-------|----------|-------------|
| SEALING RINGS | | | | | |
| N.I. | Ring Kit | 1 | 02-Up | 63175 | N.L. |
| VALVE BODY RECALIBRATION KITS | | | | | |
| N.I. | Reprogramming Kit™ (RE5R05A) (Transgo®)..... | 1 | 02-08 | T63169 | RE5R05A-HD2 |
| GASKETS & O-RINGS | | | | | |
| 300I | Gasket, Pan (Fiber) (Exc 05-Up Kia) | 1 | 02-Up | 63300 | N.L. |
| 300I | Gasket, Pan (Fiber) (05-Up Kia) | 1 | 05-Up | 63300A | N.L. |
| 305 | Gasket, Extension Housing (2WD) | 1 | 03-Up | 63305 | N.L. |
| 305 | Gasket, Extension Housing (4WD) | 1 | 04-Up | 63305A | N.L. |
| N.I. | Valve Body Gasket Kit | 1 | 02-Up | 63320K | N.L. |
| TECHNICAL MANUALS | | | | | |
| N.I. | Tech Manual (ATSG)..... | 1 | 02-Up | 63400 | RE5R05A |
| N.I. | Diagnostic Guide (Nissan, Infinity) (ATSG)..... | 1 | 02-Up | 63400T | RE5R05A DG |
| ELECTRICAL COMPONENTS | | | | | |
| 410 | Switch, MLPS..... | 1 | 02-Up | 63410 | N.L. |
| 421E | Solenoid, PWM (# 260 130 031) (Line Pressure, TCC, Front Brake Band)..... | 3 | 02-Up | 63421 | N.L. |
| 425E | Solenoid, PWM w/ Cap (# 260 130 030) (High-Low/Reverse, Input, Direct) | 3 | 02-Up | 63425 | N.L. |
| 431E | Solenoid, Low Coast Clutch (12 OHM) | 1 | 02-Up | 63431B | N.L. |
| 431E | Solenoid, Low Coast Clutch (28 OHM) (# 260 120 042)..... | 1 | 02-Up | 63431A | N.L. |
| N.I. | Sensor, Output Speed..... | 1 | 02-Up | 63436 | N.L. |
| N.I. | Sensor, TOT..... | 1 | 02-Up | 63437 | N.L. |
| N.I. | Sensor, Input Speed (w/ Press Manifold Switch) | 1 | 02-Up | 63438 | N.L. |
| N.I. | Connector, Case (w/ Harness) (3 External Plugs) | 1 | 02-Up | 63445 | N.L. |
| PUMPS | | | | | |
| 500A | Pump Assembly (Non Stepped)..... | 1 | 02-Up | 63500 | N.L. |
| 500A | Pump Assembly (Stepped, 3.120" Long Stator)..... | 1 | 02-Up | 63500B | N.L. |
| 500A | Pump Assembly (Stepped, 3.500" Long Stator)..... | 1 | 02-Up | 63500A | N.L. |
| 510A | Pump Body w/ Gears | 1 | 02-Up | 63510 | N.L. |
| 520A | Pump Cover (5.880" Long Stator Tube) | 1 | 02-Up | 63520 | N.L. |
| 520A | Pump Cover (6.250" Long Stator Tube)..... | 1 | 02-Up | 63520A | N.L. |
| 530A | Pump Gears (Milled Flats on Inner Gear) (13 Lugs)..... | 1 | 02-Up | 63530 | N.L. |
| DRUMS & CLUTCH HUBS | | | | | |
| 554A | Drum, Input (7.400" Tall, 102T Ring Gear)..... | 1 | 02-Up | 63554C | N.L. |
| 554A | Drum, Input (7.400" Tall, 106T Ring Gear)..... | 1 | 02-Up | 63554B | N.L. |
| 554A | Drum, Input (7.750" Tall, 102T Ring Gear)..... | 1 | 02-Up | 63554A | N.L. |
| 554A | Drum, Input (7.750" Tall, 106T Ring Gear)..... | 1 | 02-Up | 63554 | N.L. |
| 555G | Drum, Direct (40T Clutch Hub) | 1 | 02-Up | 63555A | N.L. |
| 555G | Drum, Direct (50T Clutch Hub) | 1 | 02-Up | 63555 | N.L. |
| 557B | Drum, Hi/Lo (2.700" Tall, Aluminum) | 1 | 02-Up | 63557B | N.L. |
| 557B | Drum, Hi/Lo (3.150" Tall, Aluminum) | 1 | 02-Up | 63557 | N.L. |
| 557B | Drum, Hi/Lo (3.150" Tall, Steel)..... | 1 | 02-Up | 63557A | N.L. |
| 577B | Hub, Hi/Lo (46 Splines)..... | 1 | 02-Up | 63577 | N.L. |
| 579C | Hub, Low Coast (42 Splines) | 1 | 02-Up | 63579 | N.L. |
| PLANETS | | | | | |
| 580 | Planet, Center (4 Gear, 24T Pinion Gear) (54T Sun Gear Type)..... | 1 | 02-Up | 63580A | N.L. |
| 580 | Planet, Center (4 Gear, 28T Pinion Gear) (50T Sun Gear Type)..... | 1 | 02-Up | 63580 | N.L. |
| 580 | Planet, Center (5 Gear) (53T Sun Gear Type)..... | 1 | 02-Up | 63580B | N.L. |
| 582A | Planet, Front (4 Gear) (42T Sun Gear Type) | 1 | 02-Up | 63582 | N.L. |
| 582A | Planet, Front (4 Gear) (43T Sun Gear Type) | 1 | 02-Up | 63582A | N.L. |
| 584F | Planet, Rear (4 Gear, Aluminum) (62T Sun Gear, 110T Ring Gear Type) | 1 | 02-Up | 63584 | N.L. |
| 584F | Planet, Rear (4 Gear, Aluminum) (62T Sun Gear, 98T Ring Gear Type) | 1 | 02-Up | 63584B | N.L. |
| 584F | Planet, Rear (4 Gear, Steel) (62T Sun Gear, 110T Ring Gear Type)..... | 1 | 02-Up | 63584A | N.L. |
| 584F | Planet, Rear (5 Gear, Steel) (61T Sun Gear, 99T Ring Gear Type)..... | 1 | 02-Up | 63584C | N.L. |
| 590F | Ring Gear, Center Planet (16 Lugs, 78T) | 1 | 02-Up | 63590 | N.L. |
| 594A | Ring Gear, Rear w/ Connecting Shell (98T)..... | 1 | 02-Up | 63594A | N.L. |
| 594A | Ring Gear, Rear w/ Connecting Shell (99T)..... | 1 | 02-Up | 63594B | N.L. |
| 594A | Ring Gear, Rear w/ Connecting Shell (110T)..... | 1 | 02-Up | 63594 | N.L. |

| ILL. | | QTY. | YEAR | PART No. | REF. No. |
|---|--|------|-------|----------|----------|
| SUN GEARS, SHELLS & SUPPORTS | | | | | |
| 612A | Sun Gear Drum, Front w/ 3rd Clu Sprag Assy (50T S.G., Bearing Type)..... | 1 | 02-Up | 63612A | N.L. |
| 612A | Sun Gear Drum, Front w/ 3rd Clu Sprag Assy (50T S.G., Bushing Type)..... | 1 | 02-Up | 63612 | N.L. |
| 612A | Sun Gear Drum, Front w/ 3rd Clu Sprag Assy (53T Sun Gear)..... | 1 | 02-Up | 63612C | N.L. |
| 612A | Sun Gear Drum, Front w/ 3rd Clu Sprag Assy (54T Sun Gear)..... | 1 | 02-Up | 63612B | N.L. |
| 610F | Sun Gear, Center (42T, 9.200" Long)..... | 1 | 02-Up | 63610 | N.L. |
| 610F | Sun Gear, Center (42T, 9.500" Long)..... | 1 | 02-Up | 63610A | N.L. |
| 610F | Sun Gear, Center (43T, 9.500" Long)..... | 1 | 02-Up | 63610B | N.L. |
| 614B | Sun Gear, Rear w/ High Clutch Sprag Assembly (61T Sun Gear)..... | 1 | 02-Up | 63614A | N.L. |
| 614B | Sun Gear, Rear w/ High Clutch Sprag Assembly (62T Sun Gear)..... | 1 | 02-Up | 63614 | N.L. |
| 632C | Support, Rear (2.540" Tall Center Hub)..... | 1 | 02-Up | 63632 | N.L. |
| 632C | Support, Rear (3.250" Tall Center Hub)..... | 1 | 02-Up | 63632A | N.L. |
| ONE WAY CLUTCHES | | | | | |
| 644 | Sprag Assembly, 1st (28 Element) (.560" thick)..... | 1 | 02-Up | 63644 | N.L. |
| 644 | Sprag Assembly, 1st (28 Element) (.840" thick)..... | 1 | 02-Up | 63644A | N.L. |
| 658C | Sprag, Forward (26 Element)..... | 1 | 02-Up | 63658 | N.L. |
| 658C | Sprag, Forward (28 Element)..... | 1 | 02-Up | 63658A | N.L. |
| 656A | Sprag Assembly, 3rd (26 Element)..... | 1 | 02-Up | 63656 | N.L. |
| 656A | Sprag Assembly, 3rd (28 Element)..... | 1 | 02-Up | 63656A | N.L. |
| 654B | Sprag, 1st (28 Element) (.560" thick)..... | 1 | 02-Up | 63654 | N.L. |
| 654B | Sprag, 1st (28 Element) (.840" thick)..... | 1 | 02-Up | 63654A | N.L. |
| SHAFTS | | | | | |
| 678D | Output (2wd) (19.900") (5.500" From End to Ring Groove)..... | 1 | 02-Up | 63678AA | N.L. |
| 678D | Output (2wd) (19.900") (6.200" From End to Ring Groove)..... | 1 | 02-Up | 63678 | N.L. |
| 678D | Output (4wd) (18.000")..... | 1 | 02-Up | 63678A | N.L. |
| 678D | Output (4wd) (18.500")..... | 1 | 02-Up | 63678C | N.L. |
| 678D | Output (4wd) (19.900")..... | 1 | 02-Up | 63678AA | N.L. |
| VALVE BODIES | | | | | |
| 740E | Low OHM Solenoid (10-15) (Non TCM)..... | 1 | 02-05 | P63740-1 | N.L. |
| 740E | Low OHM Solenoid (10-15) (TCM Not Included)..... | 1 | 02-05 | P63740-3 | N.L. |
| 740E | High OHM Solenoid (20-40) (Non TCM)..... | 1 | 02-05 | P63740-2 | N.L. |
| 740E | High OHM Solenoid (20-40) (Early TCM Not Included)..... | 1 | 02-05 | P63740-4 | N.L. |
| 740E | High OHM Solenoid (20-40) (Late TCM Not Included)..... | 1 | 06-Up | P63740-5 | N.L. |
| CASES & HOUSINGS | | | | | |
| 750I | Bell Housing (12:00 Starter, 7 1/2" Bolts)..... | 1 | 02-Up | 63750C | N.L. |
| 750I | Bell Housing (3:30 Starter, 3" Bolts) (Cast VQ4W)..... | 1 | 02-Up | 63750AA | N.L. |
| 750I | Bell Housing (3:30 Starter, 6 5/16" Bolts) (Cast VH4W)..... | 1 | 02-Up | 63750BA | N.L. |
| 750I | Bell Housing (8:00 Starter, 3" Bolts) (Cast 97X30 or RXDVQ40)..... | 1 | 02-Up | 63750 | N.L. |
| 750I | Bell Housing (8:00/3:30 Starter, 3" Bolts) (Cast VQ2M)..... | 1 | 02-Up | 63750A | N.L. |
| 750I | Bell Housing (9:00 Starter, 6 5/16" Bolts)..... | 1 | 02-Up | 63750B | N.L. |
| 760I | Case (2wd) (Cast MCO)..... | 1 | 02-Up | 63760 | N.L. |
| 760I | Case (4wd) (Cast LK)..... | 1 | 02-Up | 63760D | N.L. |
| 760I | Case (4wd) (Cast MCO)..... | 1 | 02-Up | 63760C | N.L. |
| 760I | Case (Cast RXO 2W #5)..... | 1 | 02-Up | 63760B | N.L. |
| 760I | Case (Cast RXO 4W #1)..... | 1 | 02-Up | 63760A | N.L. |
| 765I | Pan, Bottom (2wd & 4wd)..... | 1 | 02-Up | 63765 | N.L. |
| 770I | Extension Housing (6.875" Long) (Cast GKC-T #1)..... | 1 | 02-Up | 63770A | N.L. |
| 770I | Extension Housing (7.750" Long) (Cast 97X06)..... | 1 | 02-Up | 63770 | N.L. |
| MISCELLANEOUS COMPONENTS | | | | | |
| 690 | Park Gear (20 Lug)..... | 1 | 02-Up | 63690 | N.L. |
| 900 | Servo Assembly (Cast 31695)..... | 1 | 02-Up | 63900 | N.L. |
| 962H | Piston, Forward..... | 1 | 02-Up | 63962 | N.L. |
| 964F | Piston, Input (Aluminum) (1.180" Thick)..... | 1 | 02-Up | 63964 | N.L. |
| 964F | Piston, Input (Aluminum) (1.260" Thick)..... | 1 | 02-Up | 63964A | N.L. |
| 964F | Piston, Input (Aluminum) (1.970" Thick)..... | 1 | 02-Up | 63964B | N.L. |
| 965G | Piston, Direct (Aluminum) (2.415" Thick)..... | 1 | 02-Up | 63965 | N.L. |
| 965G | Piston, Direct (Aluminum) (2.600" Thick)..... | 1 | 02-Up | 63965A | N.L. |
| 966C | Piston, Reverse (Aluminum) (1.020" Thick, D Type Seal)..... | 1 | 02-Up | 63966A | N.L. |
| 966C | Piston, Reverse (Aluminum) (1.020" Thick, Lip Seal)..... | 1 | 02-Up | 63966 | N.L. |
| 966C | Piston, Reverse (Aluminum) (1.200" Thick, Lip Seal)..... | 1 | 02-Up | 63966B | N.L. |
| 967B | Piston, Hi/Lo (Aluminum) (1.050" Thick)..... | 1 | 02-Up | 63967 | N.L. |
| 967B | Piston, Hi/Lo (Aluminum) (1.230" Thick)..... | 1 | 02-Up | 63967A | N.L. |
| 969H | Piston, Low/Coast..... | 1 | 02-Up | 63969 | N.L. |

